



Interroll is the most global provider of core products for material handling solutions. Headquartered in Sant'Antonino Switzerland, Interroll is present in more than 30 countries.

Additional sales contacts and addresses are available by visiting [www.interroll.com](http://www.interroll.com)

**North American  
Manufacturing Center**

Interroll Dynamic Storage  
Tel: 905-727-3399  
[ca.sales@interroll.com](mailto:ca.sales@interroll.com)

**Interroll  
Worldwide Headquarters**

Interroll Holding AG  
Via Gorelle 3  
P.O. Box 566  
CH - 6592 Sant'Antonino  
Phone: +41 91 850 25 25  
Fax: +41 91 850 25 55  
[info@interroll.com](mailto:info@interroll.com)

Interroll reserves the right to modify the technical characteristics of all its products at any time.

Technical information, dimensions, data and characteristics are provided for reference only.



MEX (55) 53 63 23 31    MTY (81) 83 54 10 18  
QRO (442) 1 95 72 60    [ventas@industrialmagza.com](mailto:ventas@industrialmagza.com)

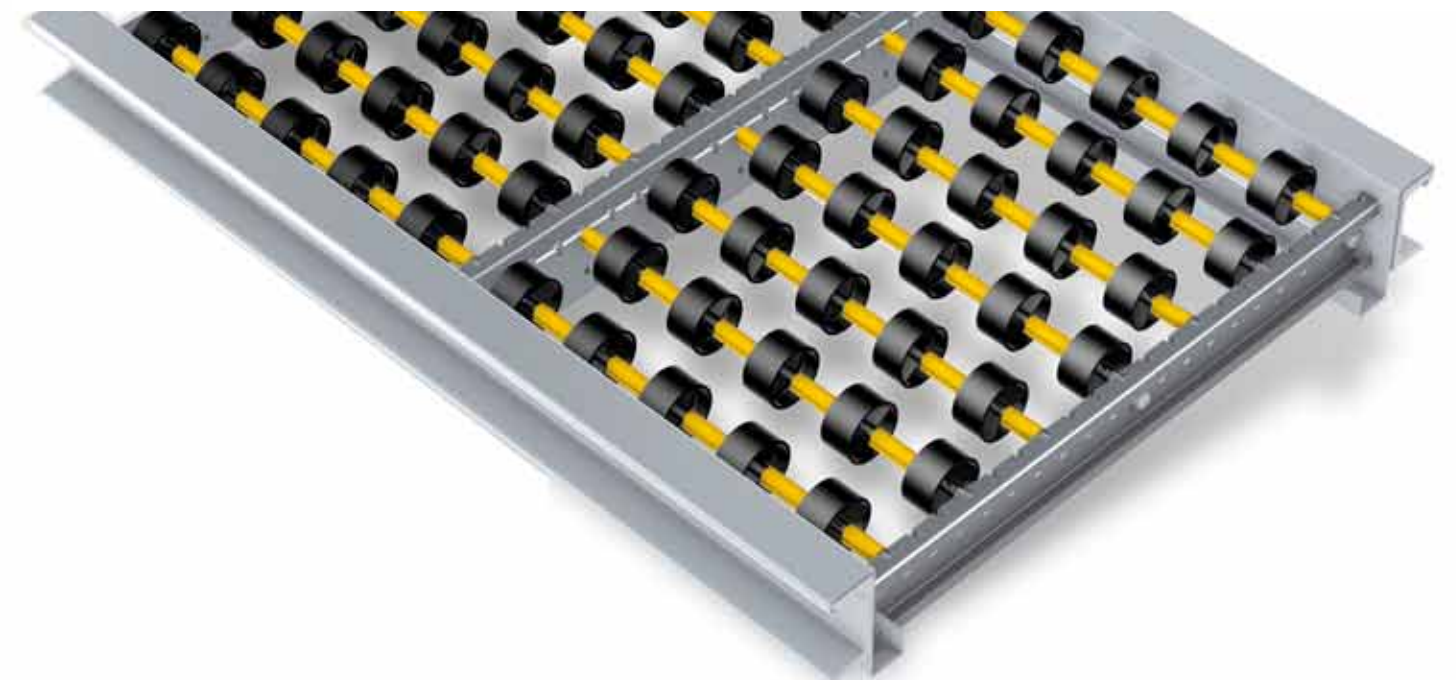

# INTERROLL VERSIFLOW CARTON WHEEL FLOW

OPTIMIZE YOUR PICKING PROCESS



MEX (55) 53 63 23 31  
QRO (442) 1 95 72 60  
MTY (81) 83 54 10 18  
[ventas@industrialmagza.com](mailto:ventas@industrialmagza.com)



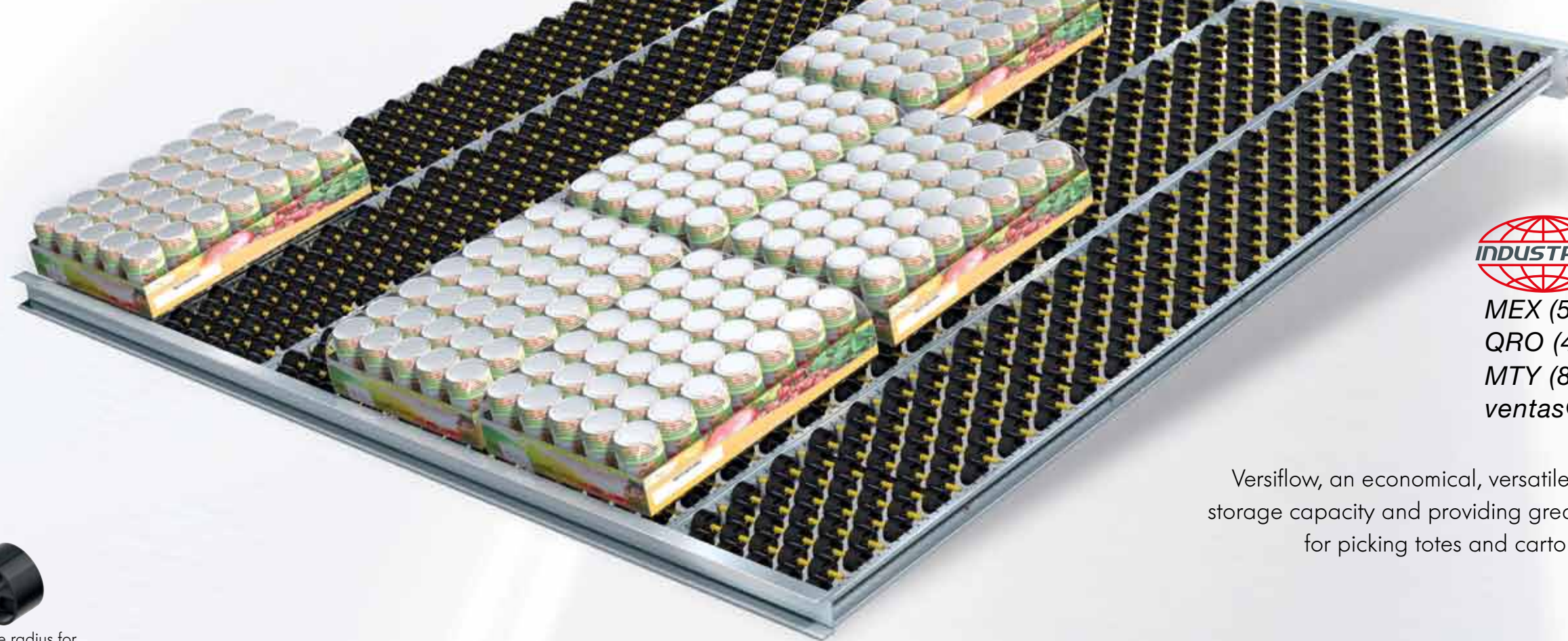

**INDUSTRIAL MAGZA**  
DIST. AUTORIZADO

MEX (55) 53 63 23 31  
QRO (442) 1 95 72 60  
MTY (81) 83 54 10 18  
ventas@industrialmagza.com

Versiflow, an economical, versatile product maximizing storage capacity and providing greater ease and speed for picking totes and cartons of varying widths.

### COMPONENTS

#### Wheels

1.9" diameter polycarbonate wheels provide a large radius for easy flowability. Wheels have a 1 inch wide rolling surface to provide excellent support for cartons or totes.



#### Galvanized steel axle

Galvanized steel axles on 2" or 3" centers ensure stability of load. Unit dimensions determine axle configurations.



### Configurations

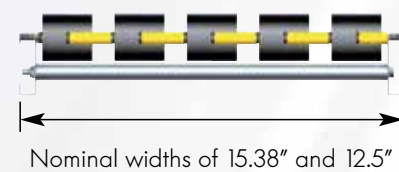

Nominal widths of 15.38" and 12.5"

Loading side Unloading side

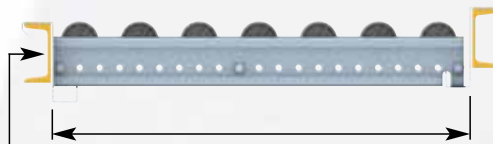

Versiflow tracks are available in any length – no splicing required even for long lengths.

Brackets are compatible with step beams, box beams, and structural beams.

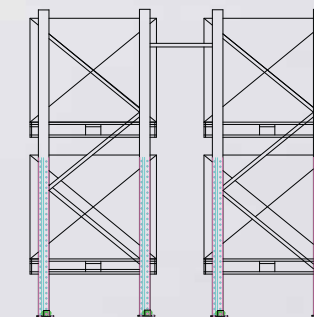

Before – Static Racking

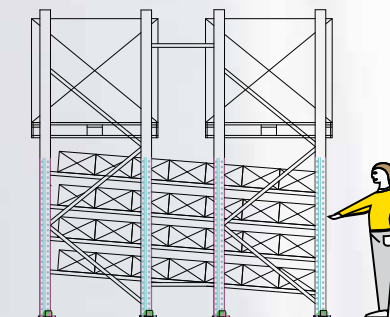

After – Interroll Versiflow

#### Guides

Interroll offers entry guides and full length guides to help the order picker.



MEX (55) 53 63 23 31  
QRO (442) 1 95 72 60  
MTY (81) 83 54 10 18  
ventas@industrialmagza.com

Entry guide

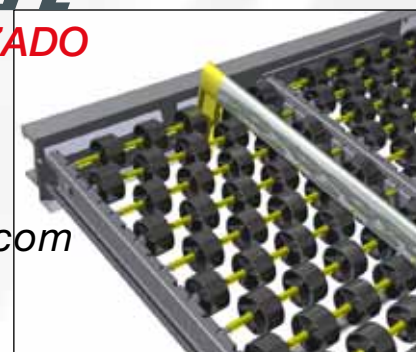

Full length guide

A 90-inch track at 15.38" or 12.5" wide can handle loads up to 500 lbs.

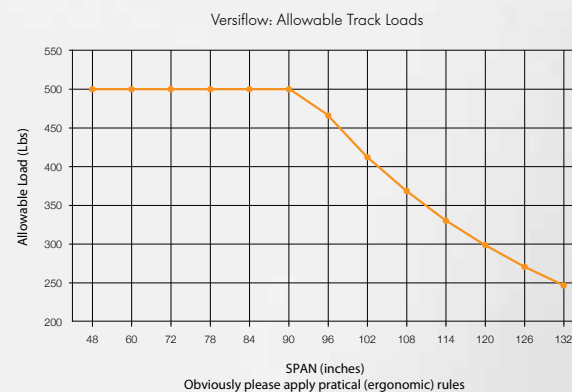

### Why use Versiflow?

- Versiflow allows FIFO picking
- Versiflow offers full bay width access for various sizes of cartons or totes
- Strong polycarbonate wheels resist impact damage and provide long wear characteristics
- High density storage with up to 90% utilization of space
- Strong profile for superior load carrying over long spans
- No special tools required to install the system
- Tracks are delivered fully assembled
- Operating temperature -30°F to 104°F